

TRAVIS COUNTY

4021

1008

1009

1007

3020

BASTROP COUNTY ELECTION PRECINCT 1008

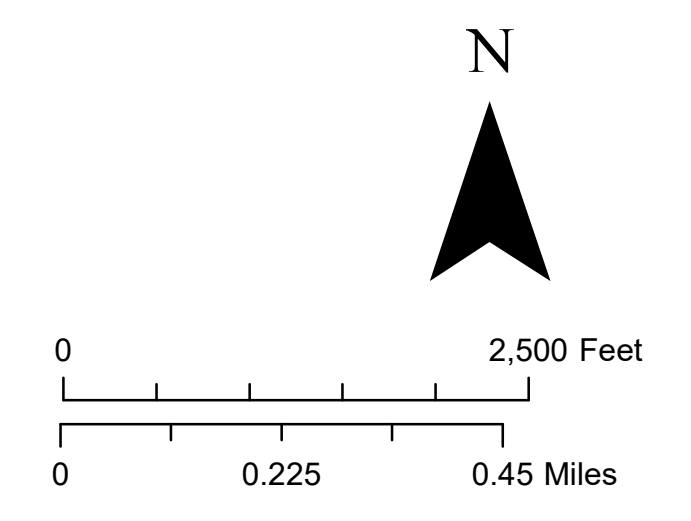

Election Precinct 1008

1001	1006	1011	1016	4021
1002	1007	1012	1017	4022
1003	1008	1013	1018	4023
1004	1009	1014	1019	4024
1005	1010	1015	1020	4025
				4026

- Public Highway
- FM Road
- Public Road
- Private Road
- Other Access
- Rail Road
- County Line
- City Limit
- Colorado River
- Lake

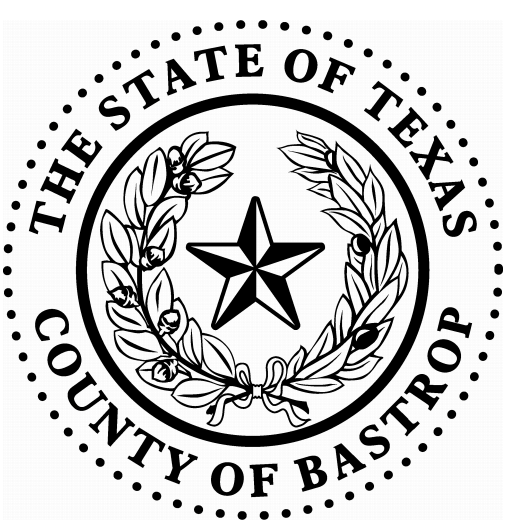

DISCLAIMER
Bastrop County provides this map "as is" and assumes no liability for its completeness or accuracy. Information shown on this map is derived from public records that are constantly undergoing change and do not replace a site survey. This product is for informational purposes and may not have been prepared for or be suitable for legal, engineering or surveying purposes. It does not represent an on-site ground survey and represents only the approximate relative location of property boundaries.

Map Title: Bastrop County Election Precinct 1008
Produced By: Bastrop County Information Technology
Author: Julie Sumner/Maptek
Date Source: 1/24/2022 at 1:50:18 PM
Bastrop County
Date Expired: 01/25/22

